

FINAL EVALUATION OF ALTERNATIVES

OPTION B.2 SITE AND ARCHITECTURAL DRAWINGS

3.3.3 - a

Option B.2 Addition / Renovation / 1600 & 1722 Student Population

Site Plan

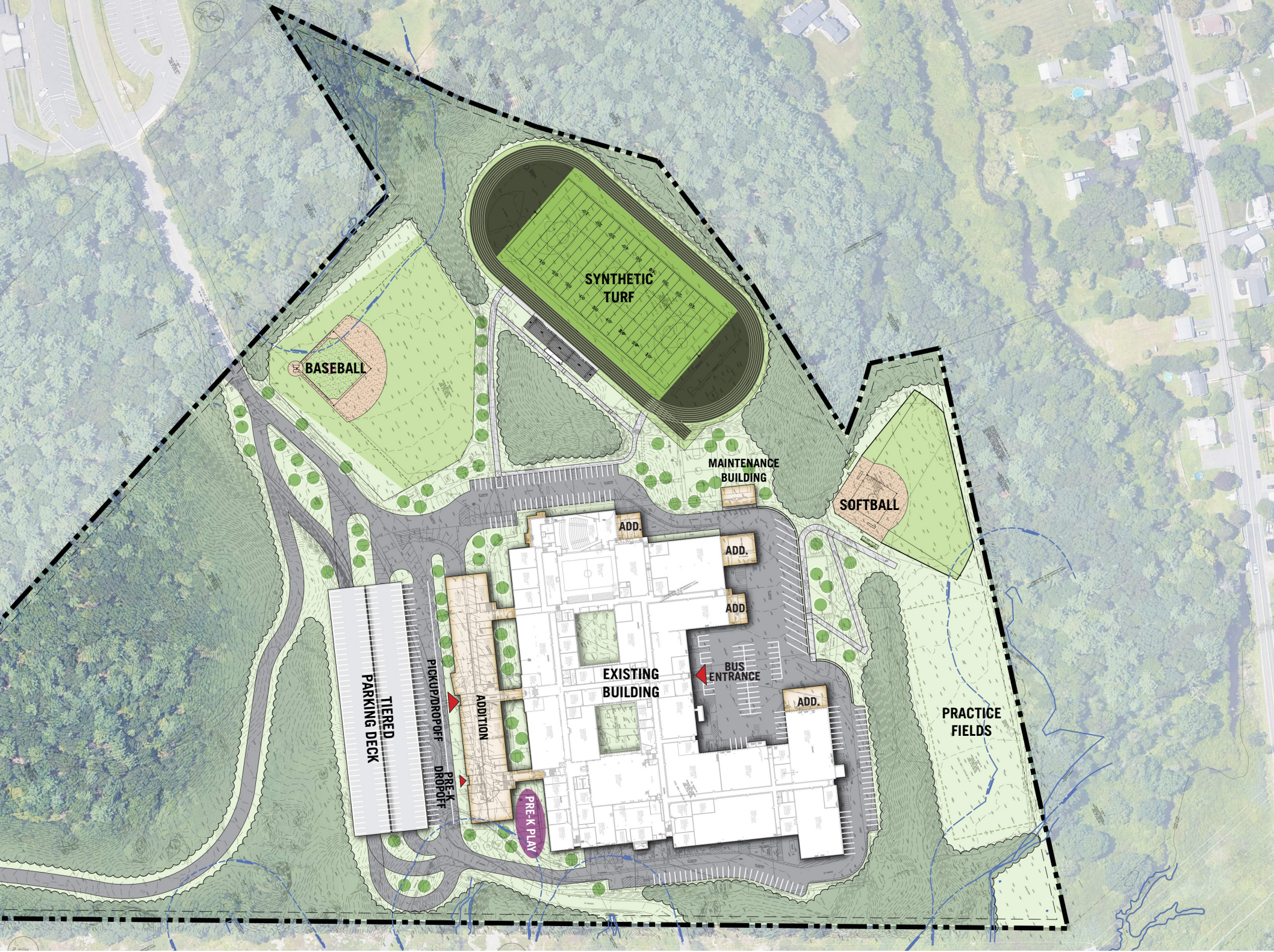

Option B.2 Addition / Renovation / 1600 & 1722 Student Population

3D View



Option B.2 Addition / Renovation / 1600 & 1722 Student Population

Building Section

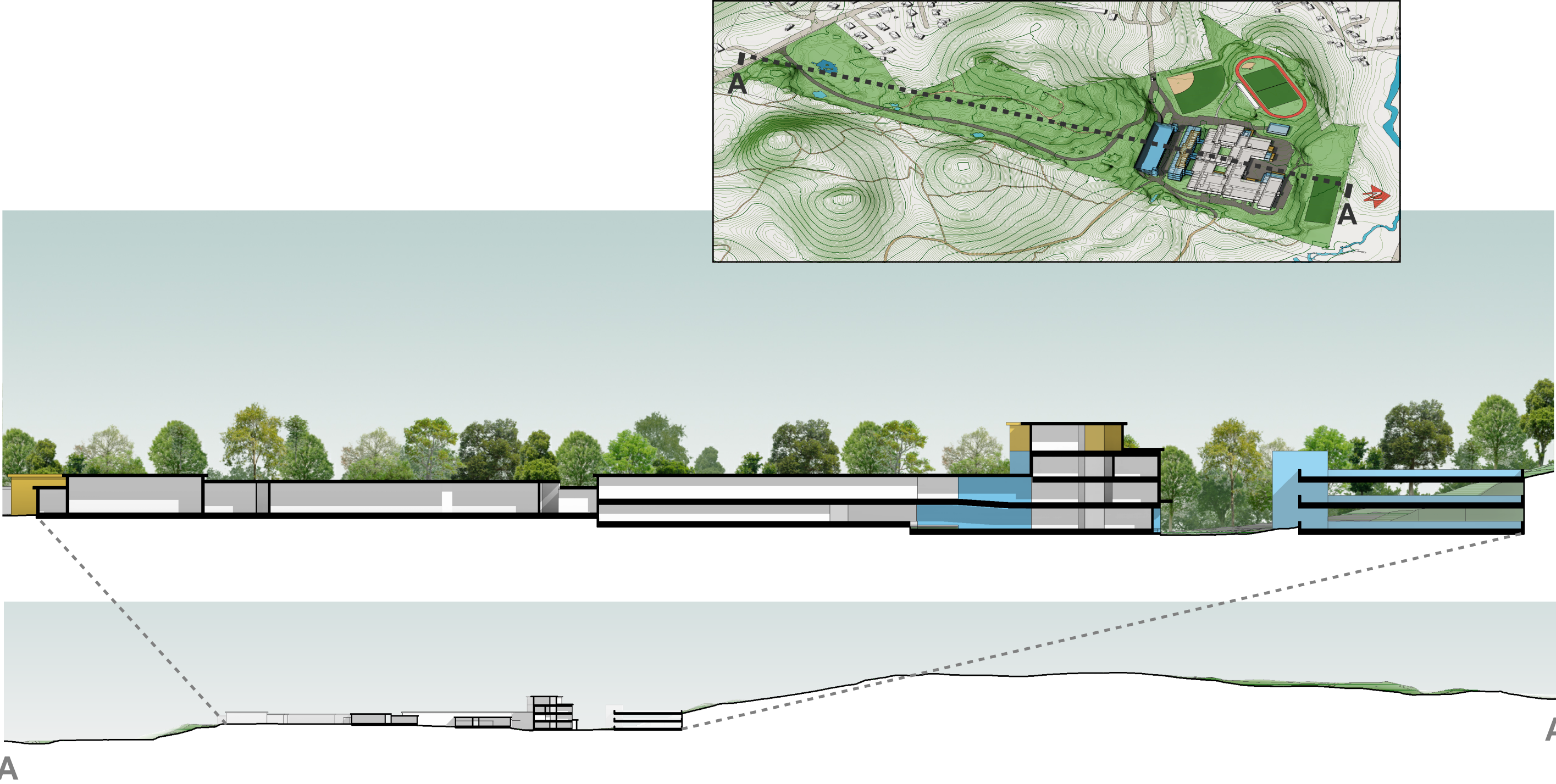

Option B.2 Addition / Renovation / 1600 Student Population

Lower Level - Floor Plan

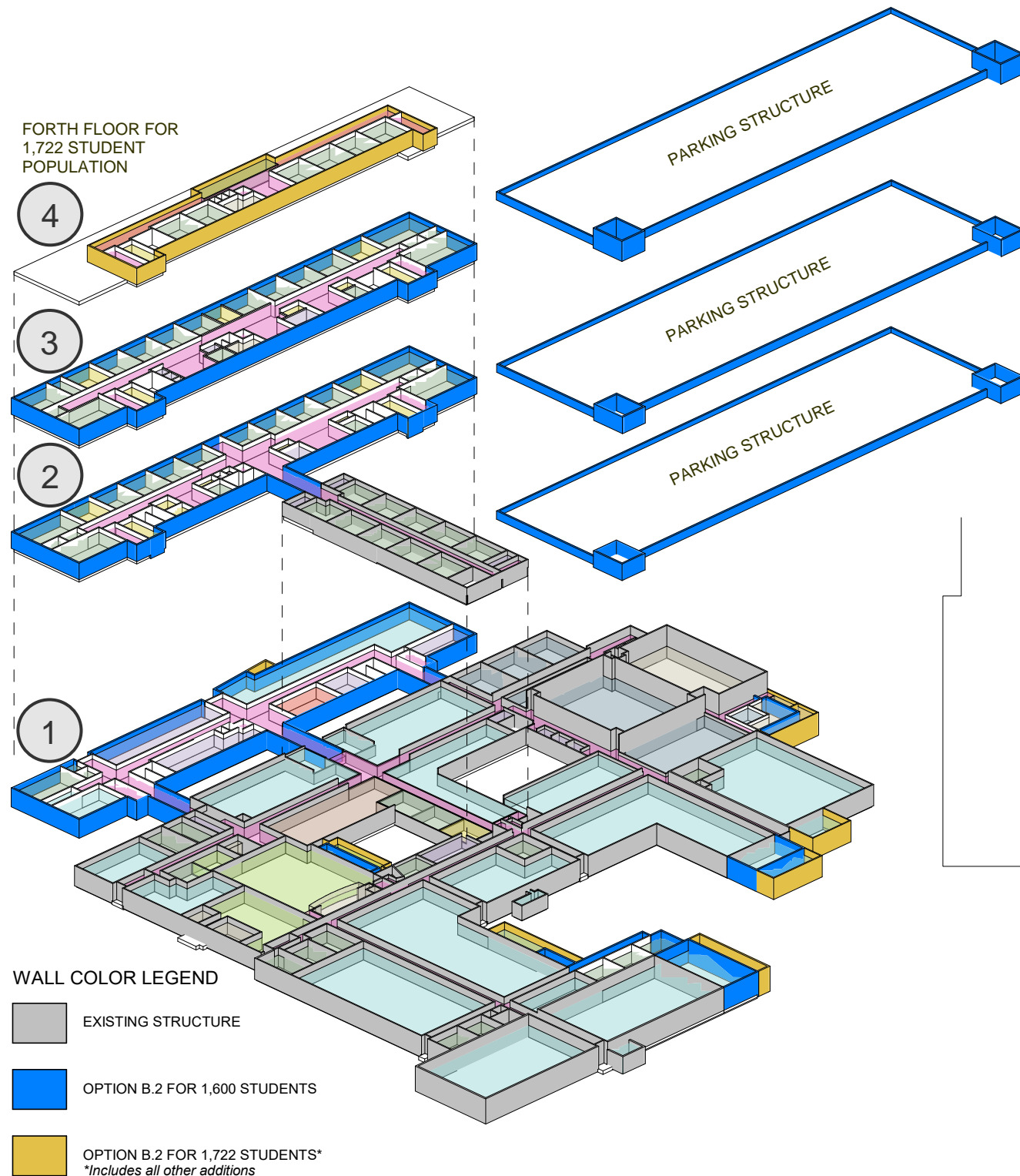

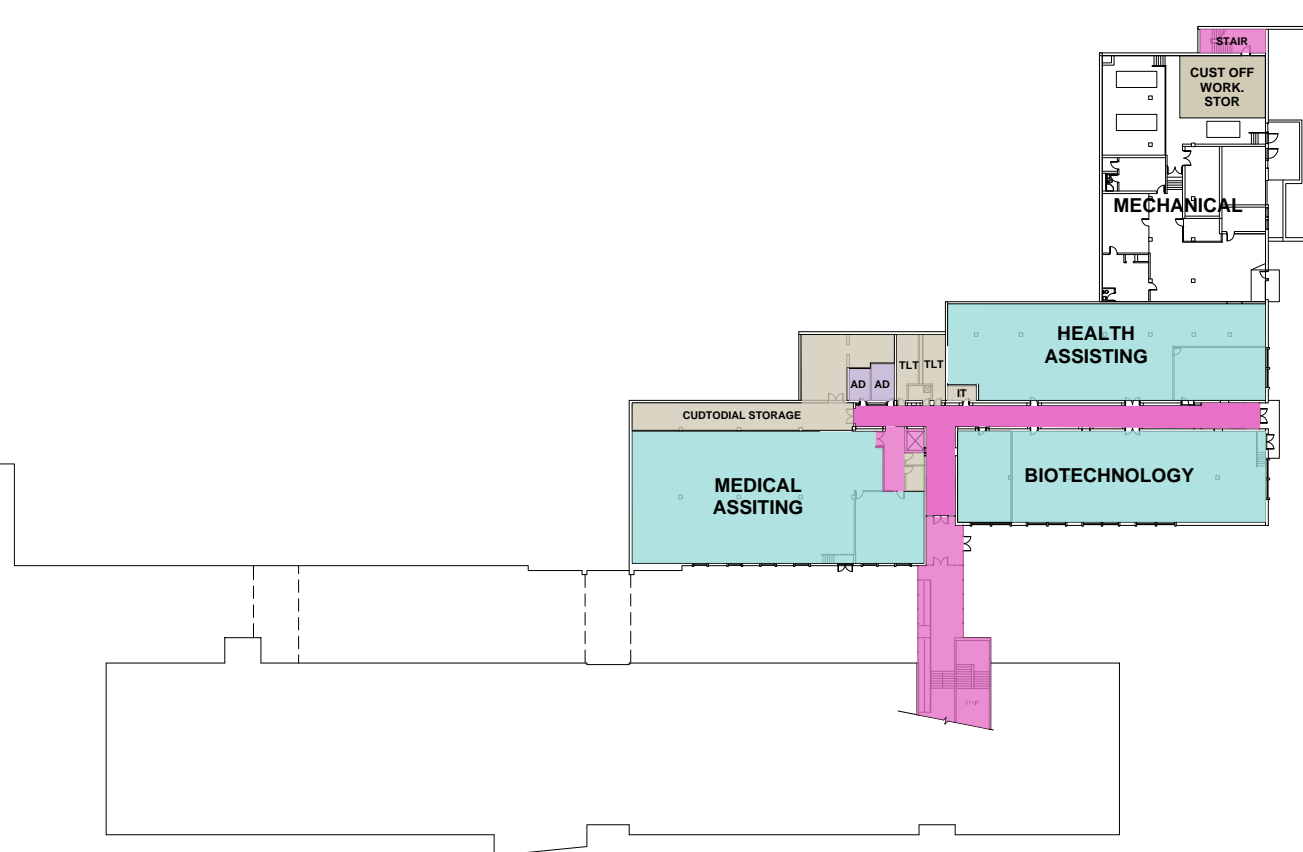

LL

- 1.0 Core Academic
- 2.0 Special Education
- 4.0 Vocations & Technology
- 5.0 Health & Physical Education
- 6.0 Media Center
- 7.0 Auditorium / Drama
- 8.0 Dining & Food Service
- 9.0 Medical
- 10.0 Administration & Guidance
- 11.0 Custodial & Maintenance
- 12.0 Other
- 13.0 Non-Programmed Spaces
- 13.1 Core



Level 1 - Floor Plan



	EXISTING STRUCTURE
	OPTION B.2 FOR 1,600 STUDENTS
	OPTION B.2 FOR 1,722 STUDENTS* <i>*Includes all other additions</i>

Level 2 - Floor Plan



Option B.2 Addition / Renovation / 1600 Student Population

Level 3 - Floor Plan

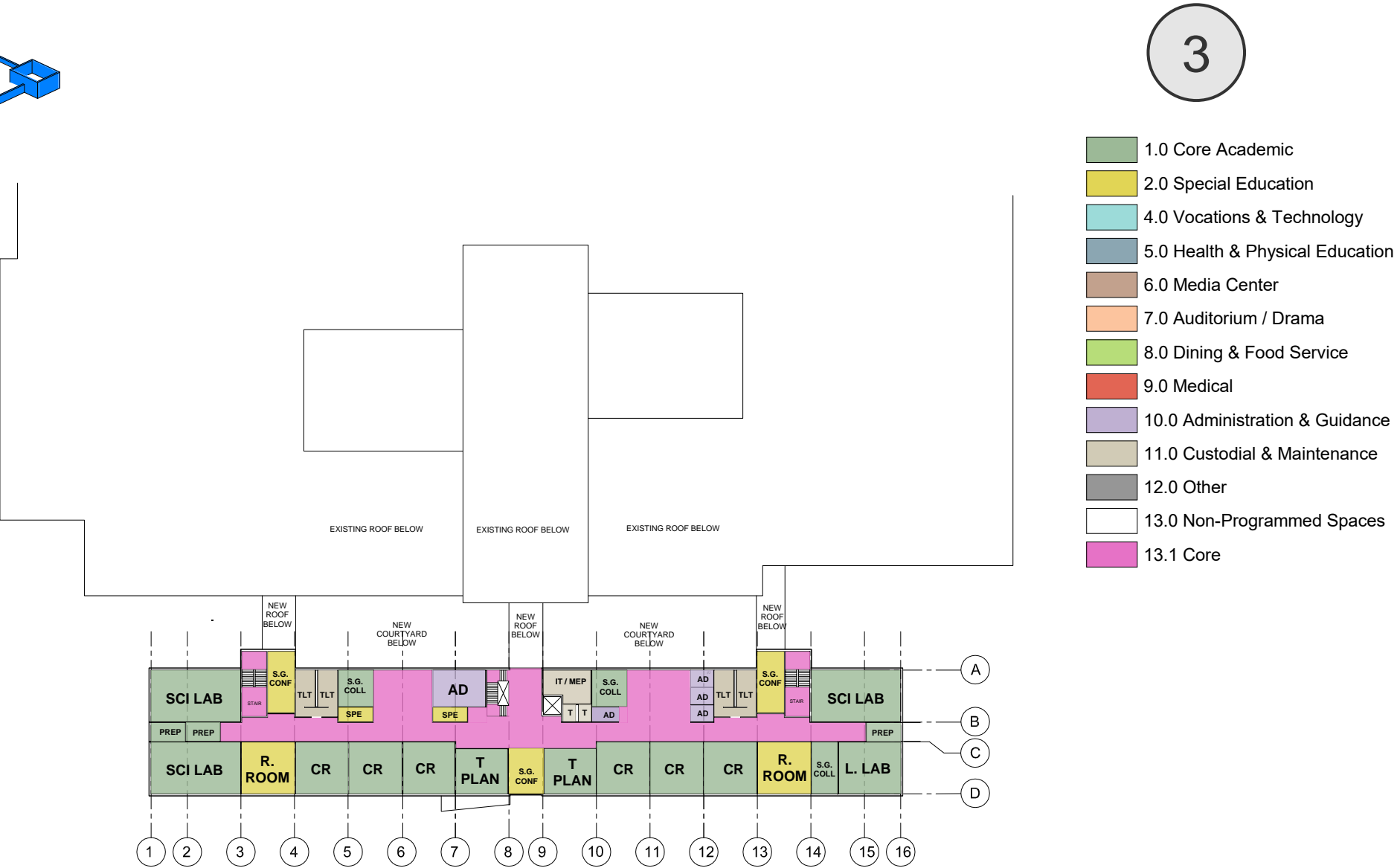
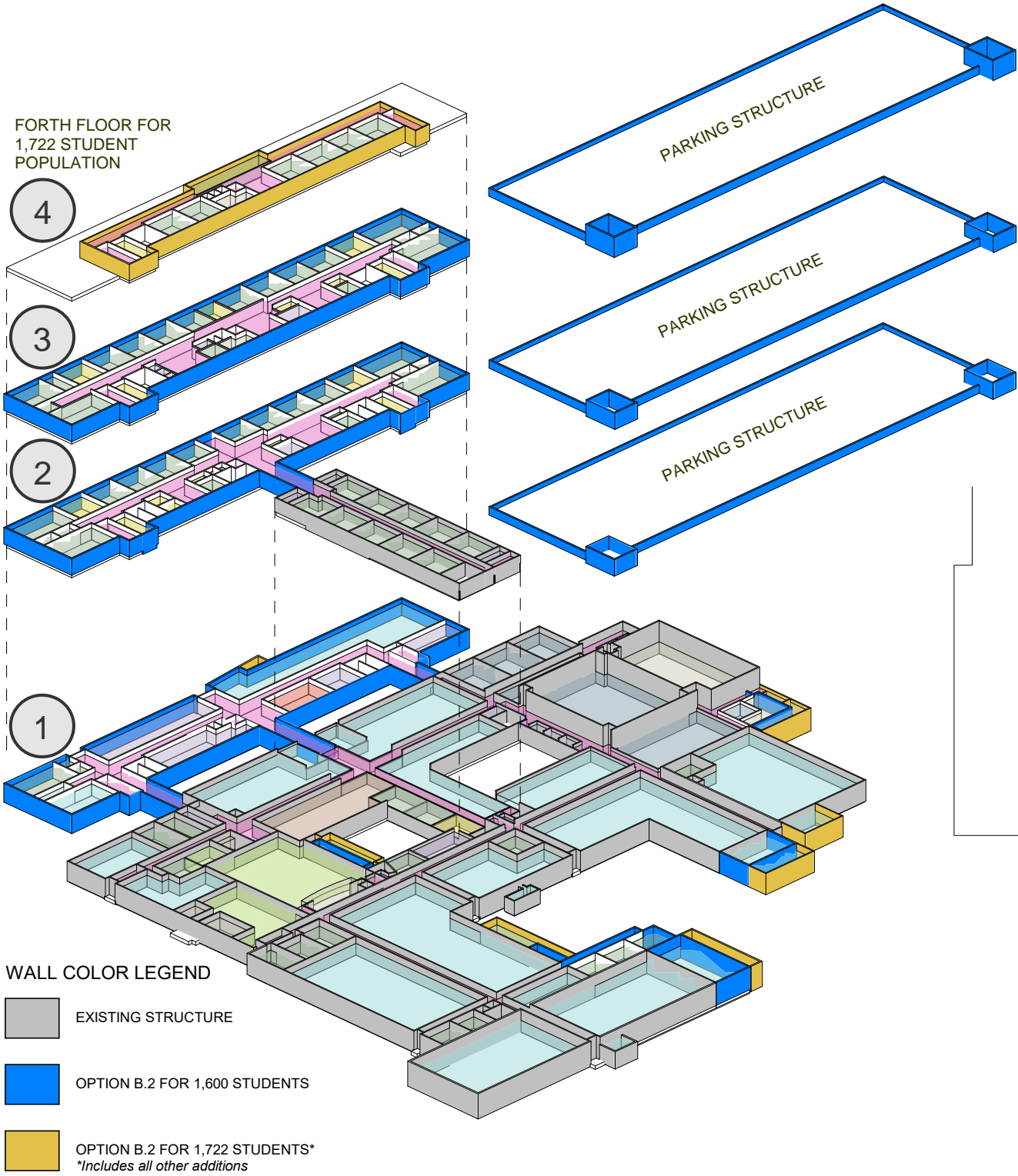

Option B.2 Addition / Renovation / 1722 Student Population

Lower Level - Floor Plan

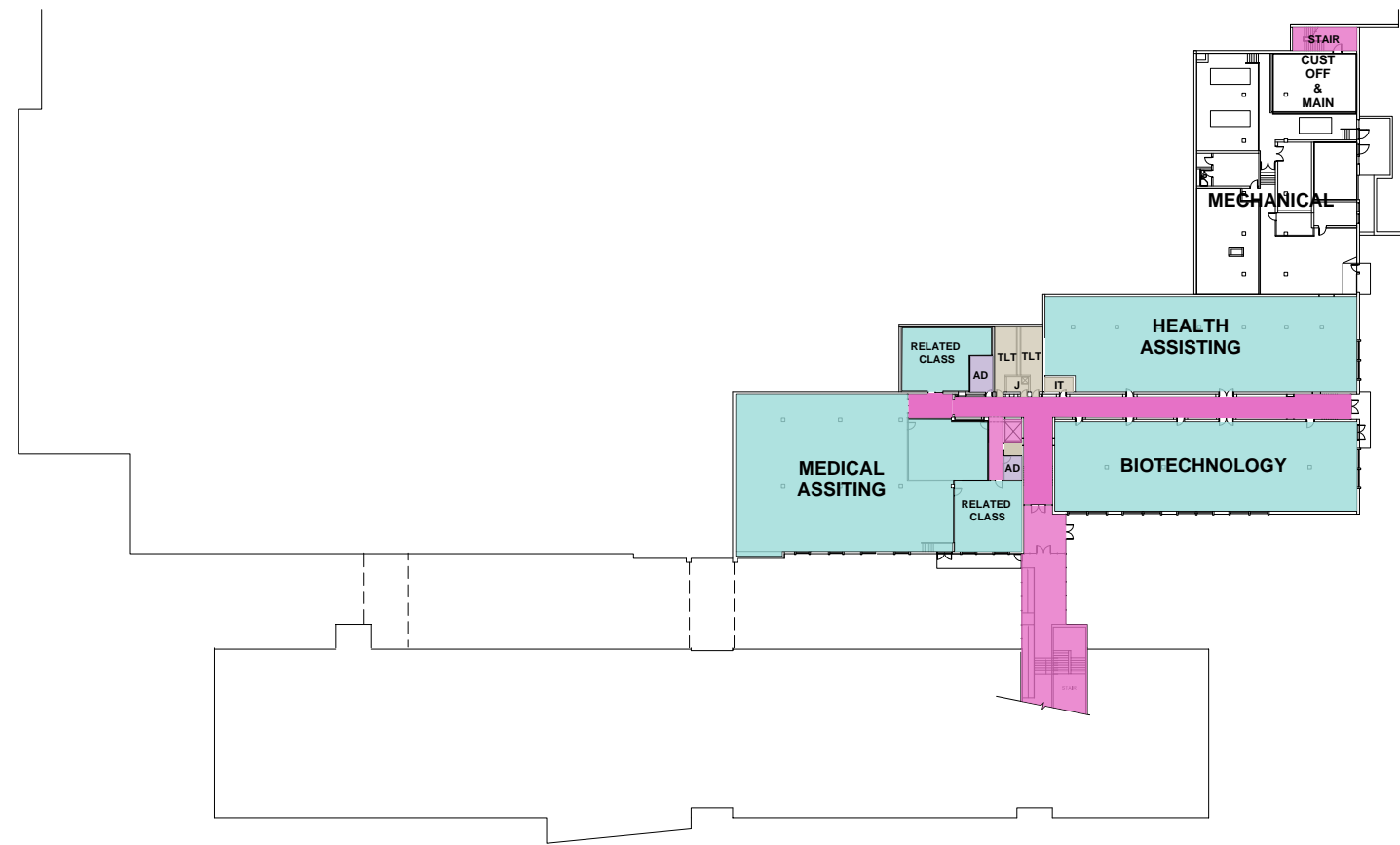
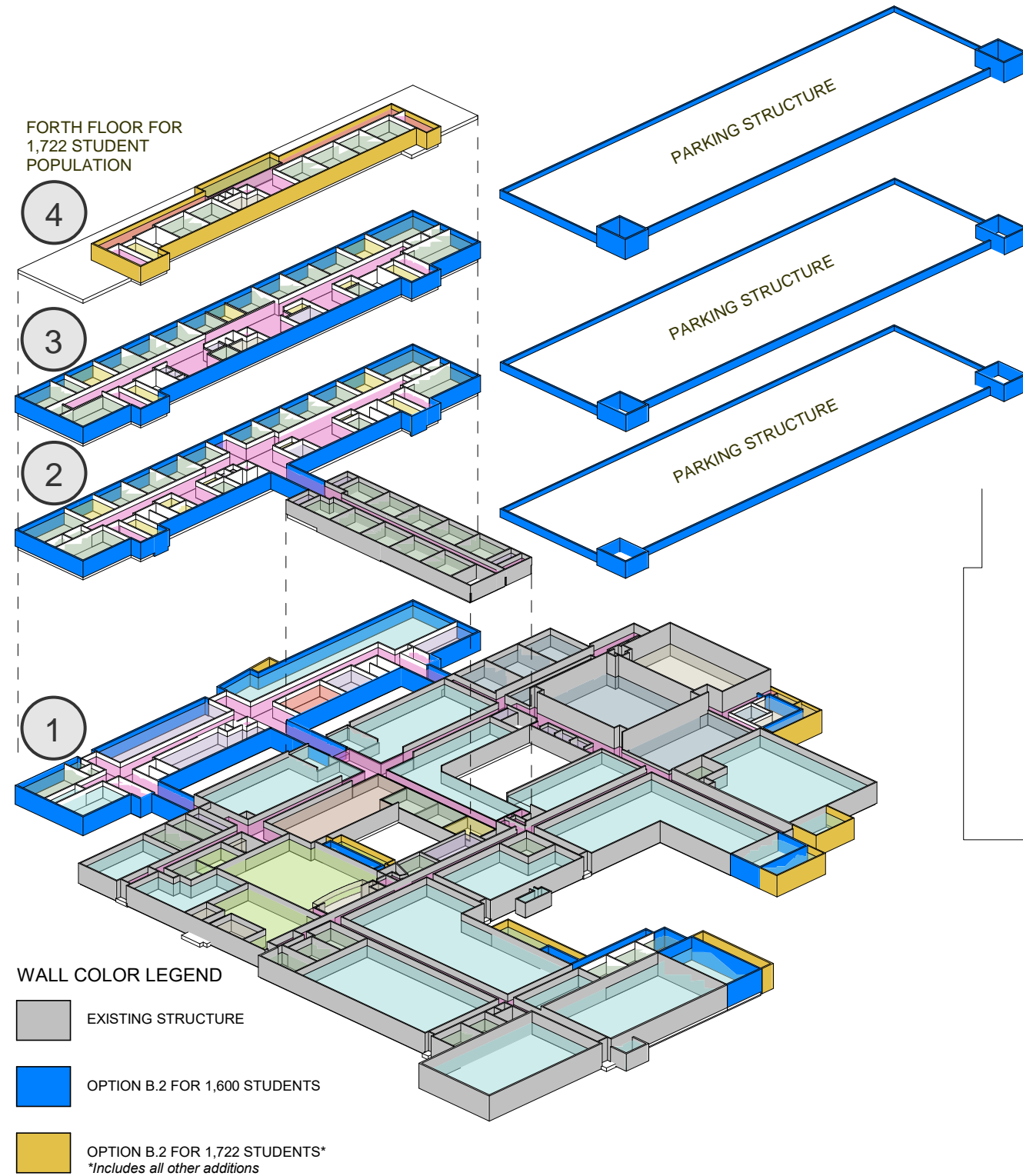

- LL
- 1.0 Core Academic
 - 2.0 Special Education
 - 4.0 Vocations & Technology
 - 5.0 Health & Physical Education
 - 6.0 Media Center
 - 7.0 Auditorium / Drama
 - 8.0 Dining & Food Service
 - 9.0 Medical
 - 10.0 Administration & Guidance
 - 11.0 Custodial & Maintenance
 - 12.0 Other
 - 13.0 Non-Programmed Spaces
 - 13.1 Core

Level 1 - Floor Plan



Level 2 - Floor Plan



Option B.2 Addition / Renovation / 1722 Student Population

Level 3 - Floor Plan

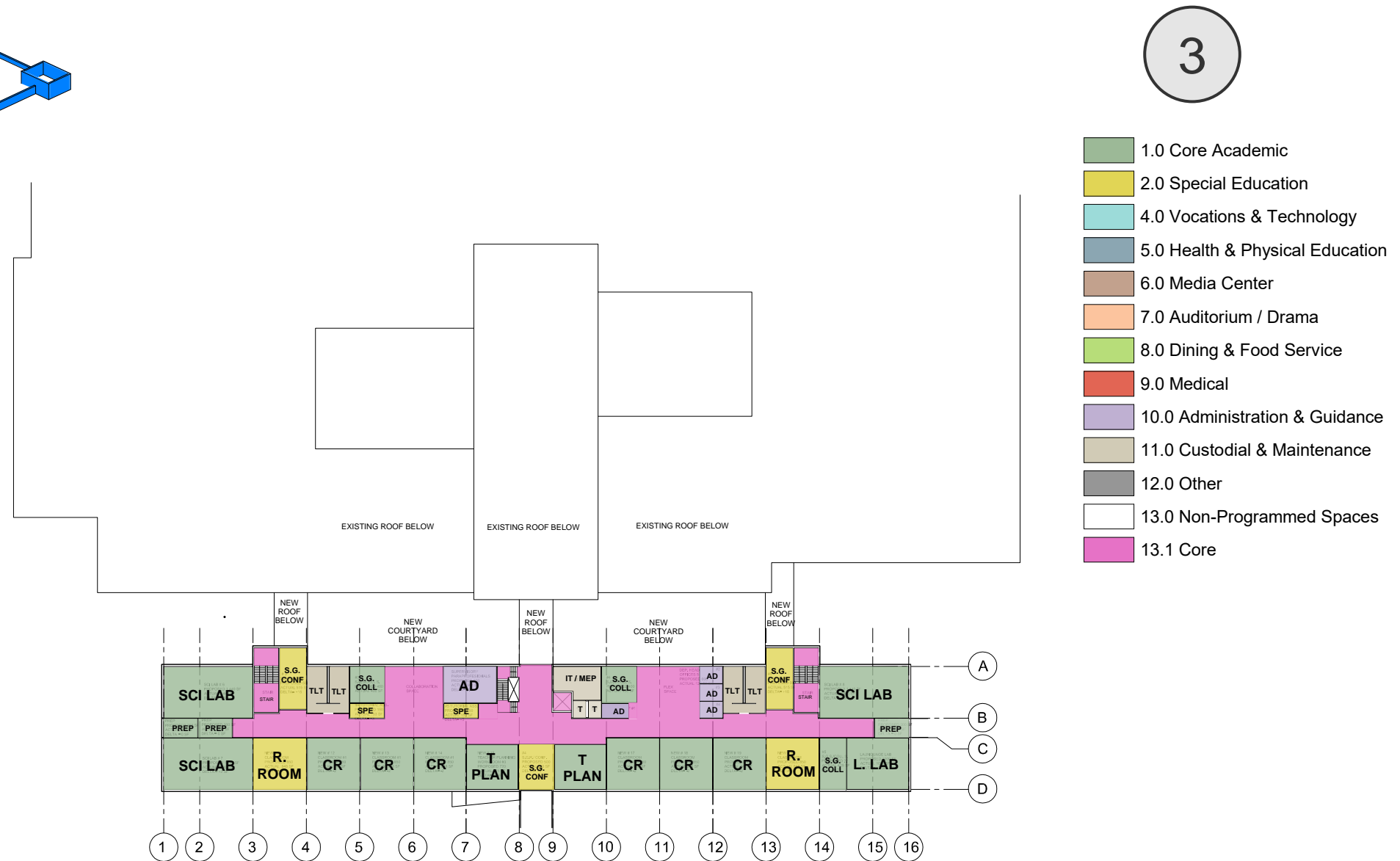
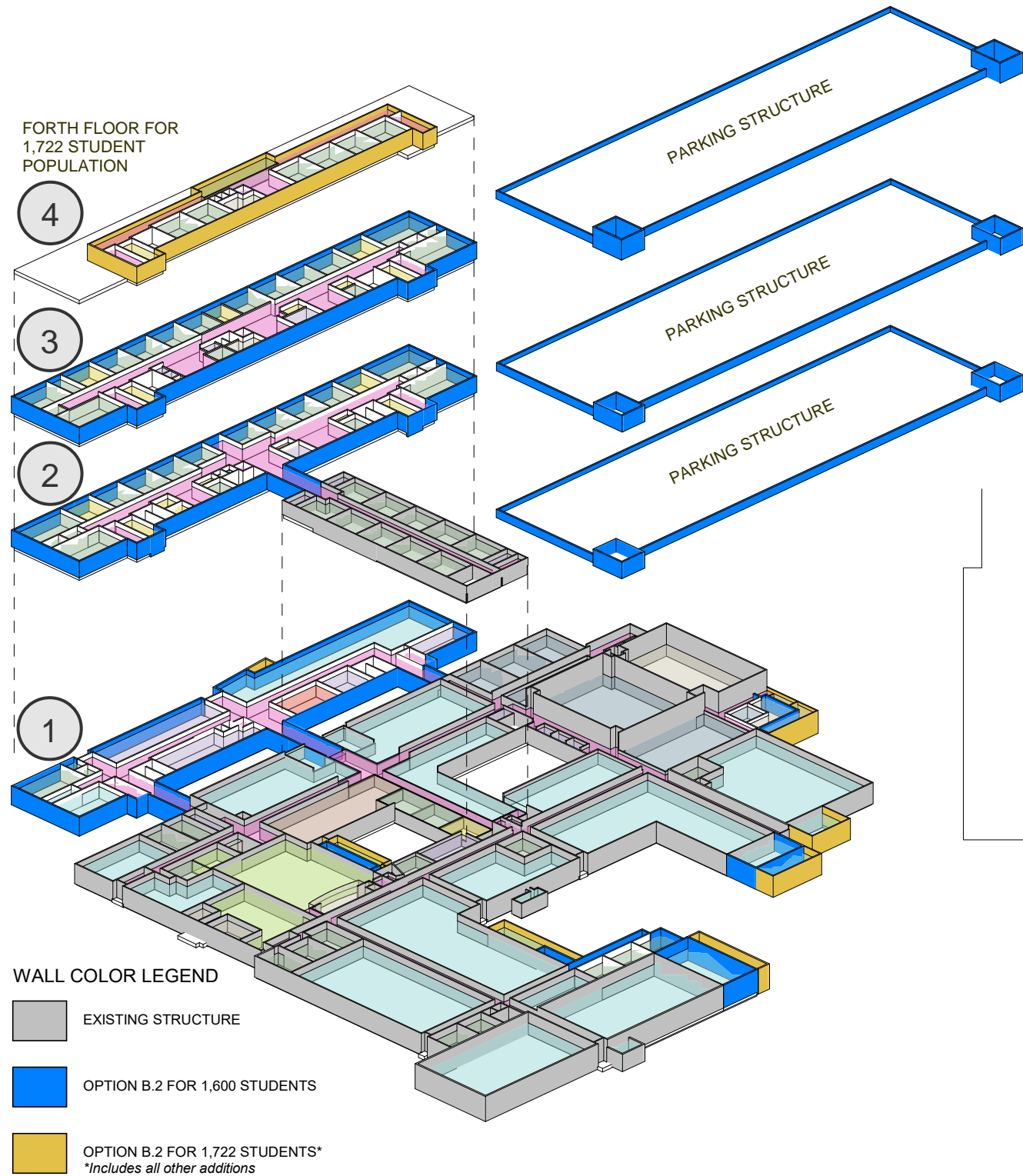

Option B.2 Addition / Renovation / 1722 Student Population

Level 4 - Floor Plan

