

FINAL EVALUATION OF ALTERNATIVES

## CONSTRUCTION PHASING DIAGRAMS

3.3.3 - f



Option B.2 Addition / Renovation / 1600 & 1722 Student Population

Construction Phasing Diagrams

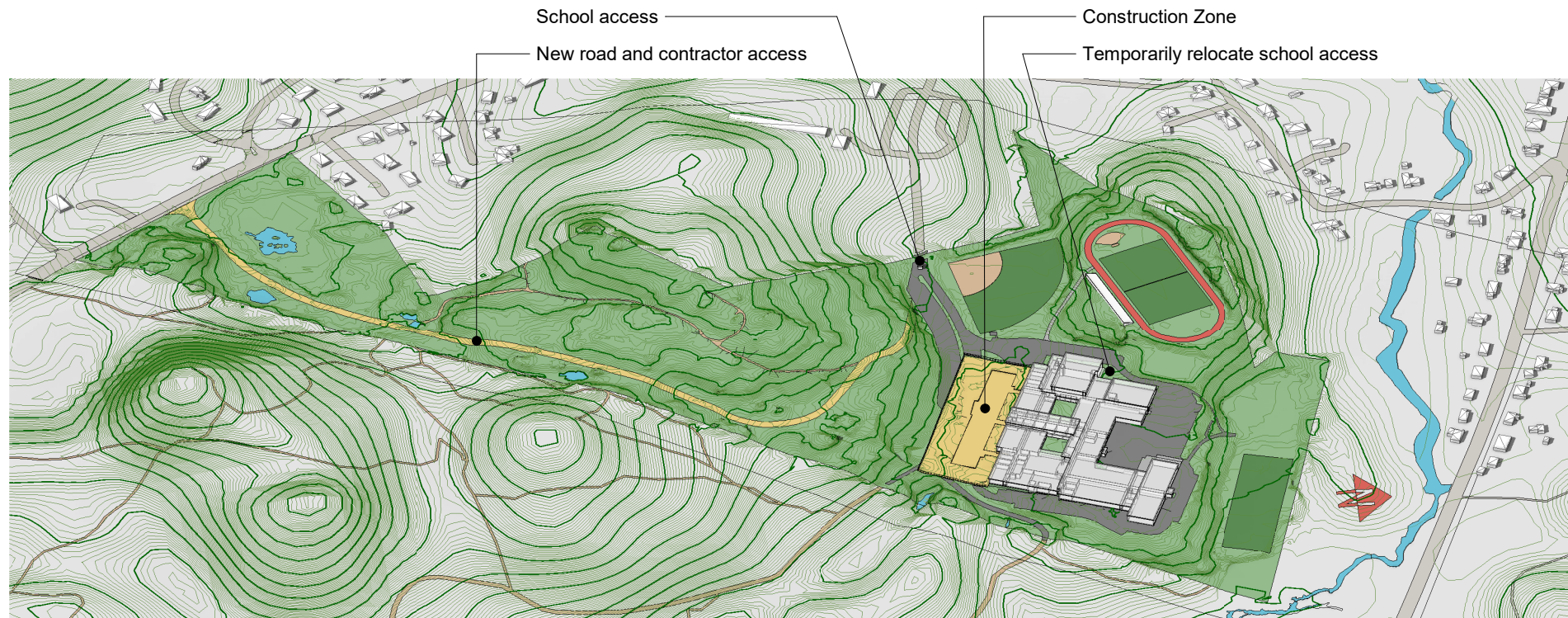

1 B.2 SITE ENABLING PACKAGE; CONSTRUCTION OF ACCESS ROAD FROM FARM STREET BEGINS SUMMER 2022

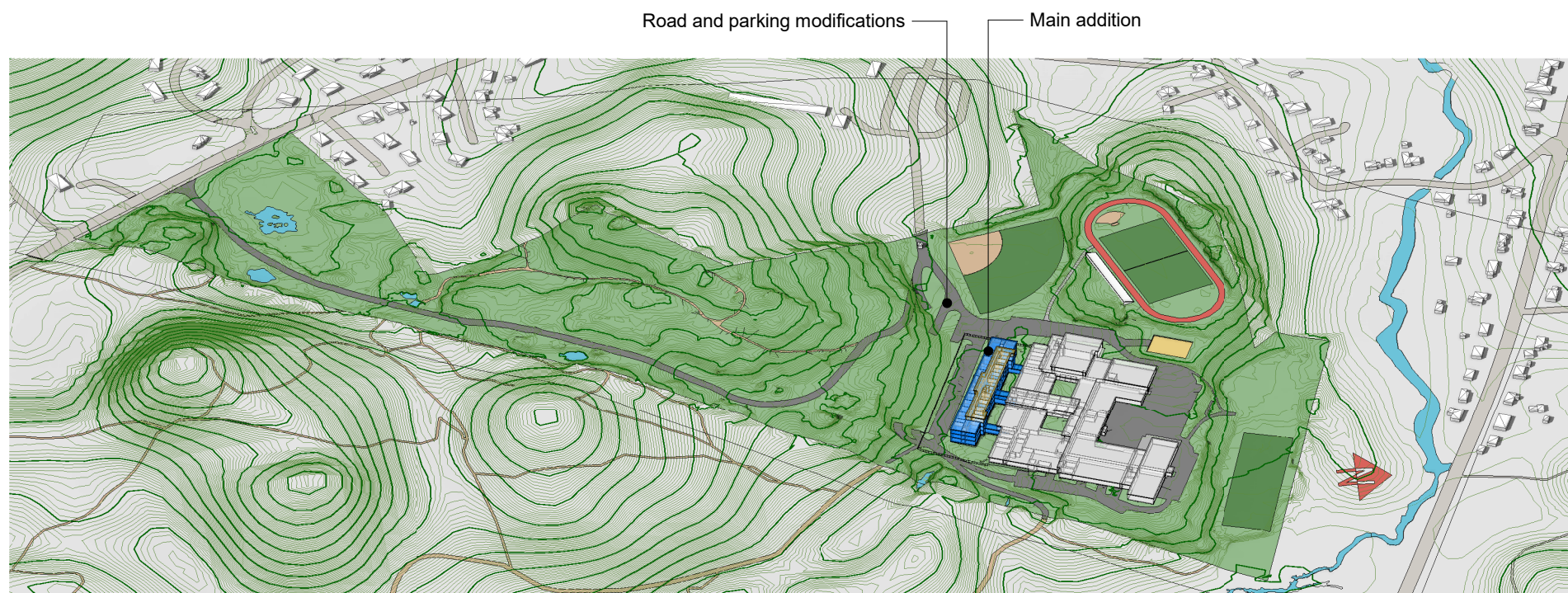

2 B.2 CONSTRUCTION OF BUILDING ADDITION BEGINS SUMMER 2023



Option B.2 Addition / Renovation / 1600 & 1722 Student Population

Construction Phasing Diagrams

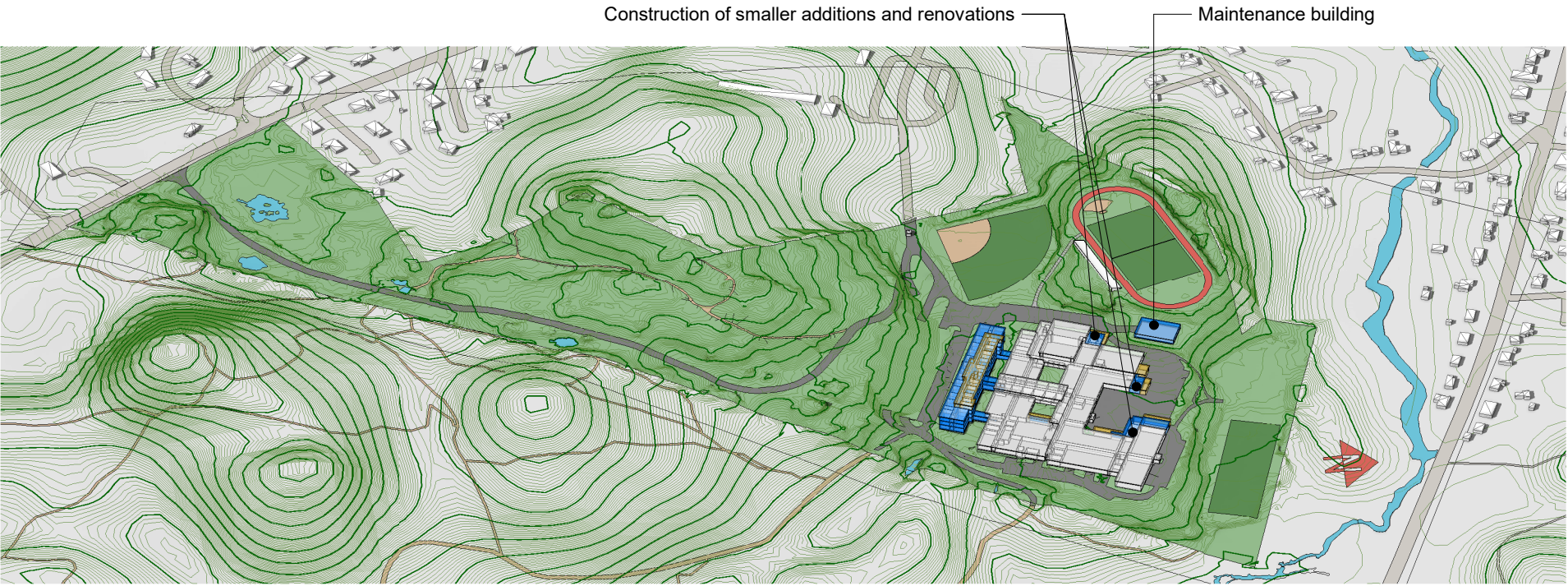

3 B.2 ADDITIONS & RENOVATIONS

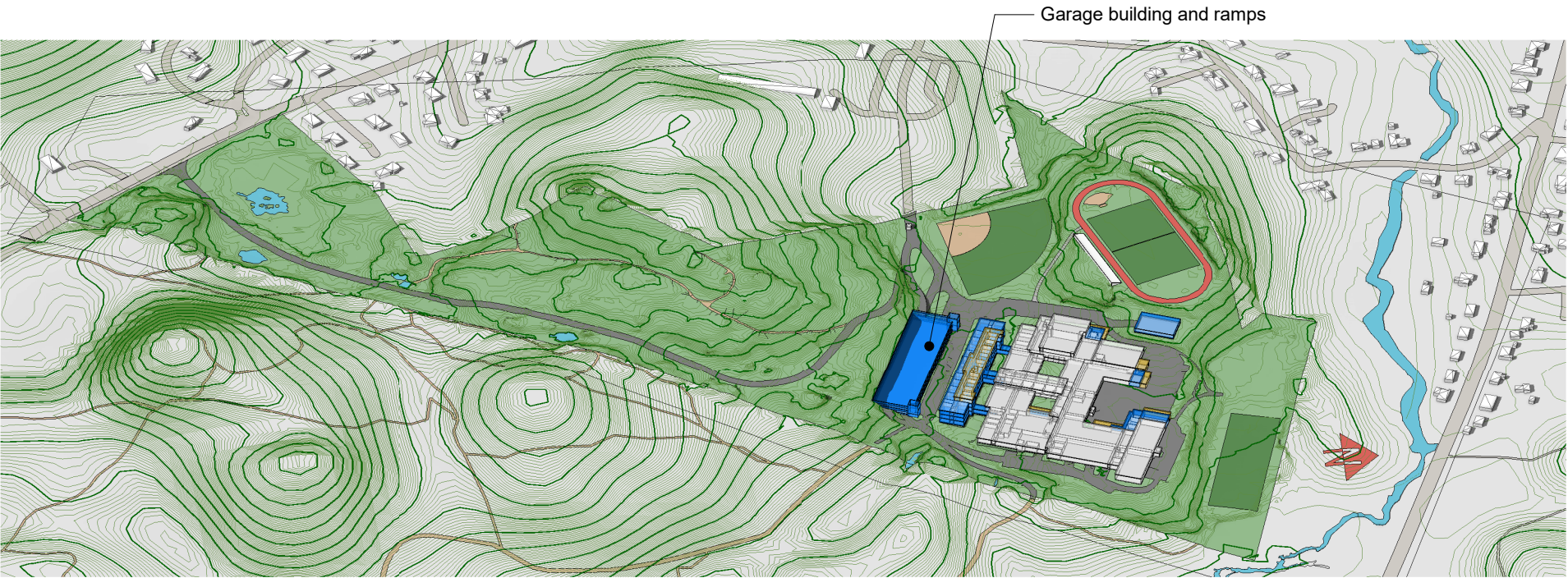

4 B.2 PARKING GARAGE AND PROJECT COMPLETION, 2026



Option C.1 New Construction

Construction Phasing Diagrams

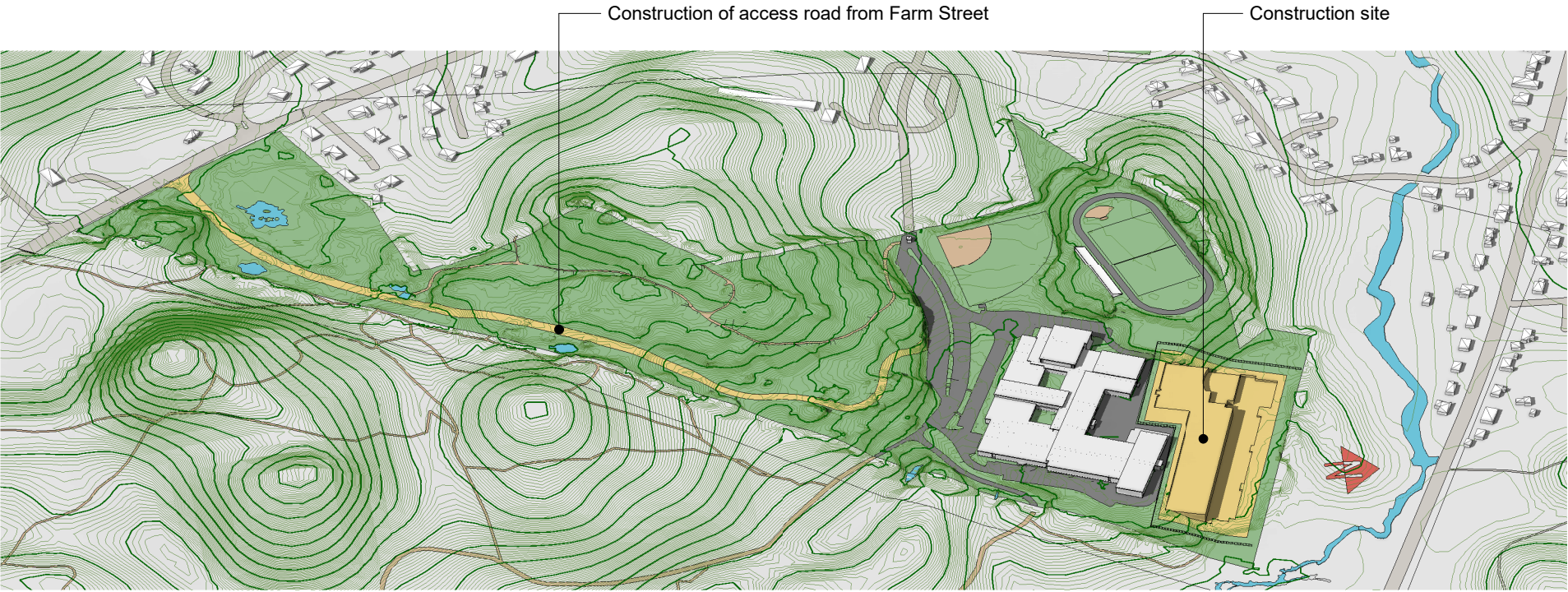

① C.1 SITE ENABLING PACKAGE; CONSTRUCTION OF ACCESS ROAD FROM FARM STREET BEGINS SUMMER 2022

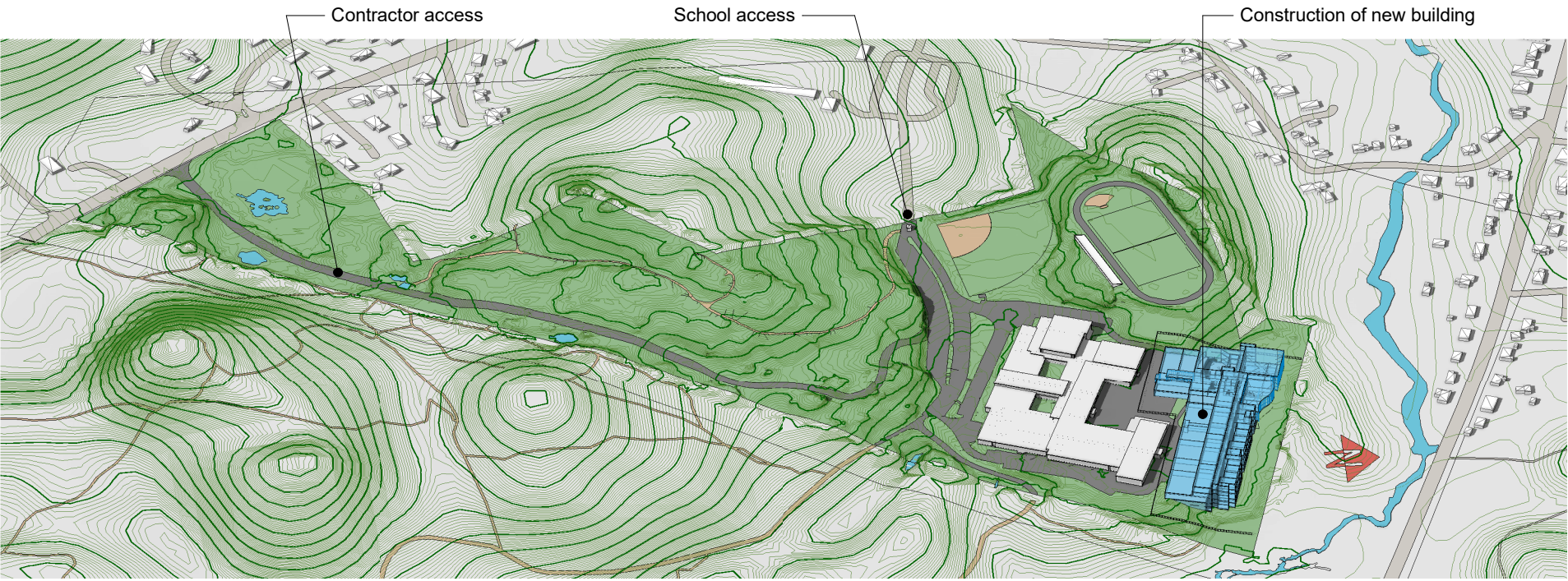

② C.1 CONSTRUCTION OF NEW SCHOOL BUILDING, BEGINS SUMMER 2023



Option C.1 New Construction

Construction Phasing Diagrams

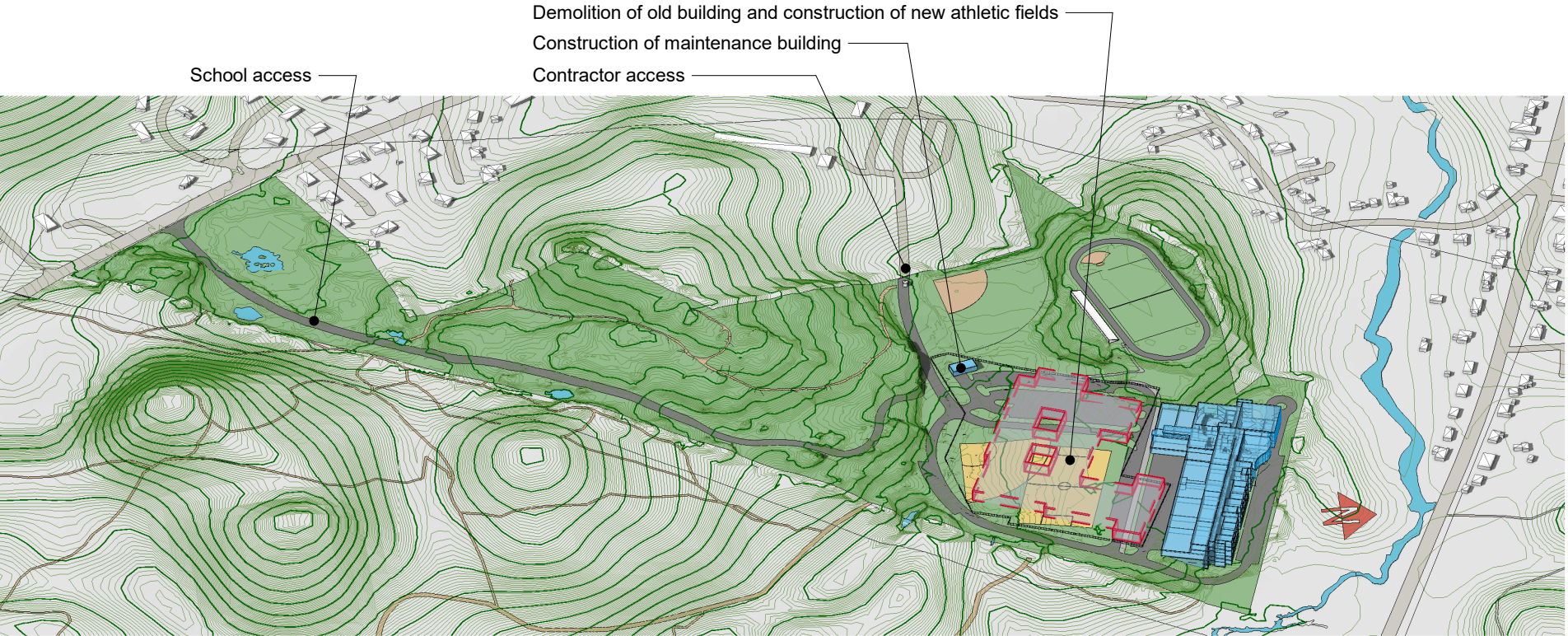

③ C.1 DEMOLITION OF EXISTING BUILDING AND CONSTRUCTION OF NEW ATHLETIC FIELDS

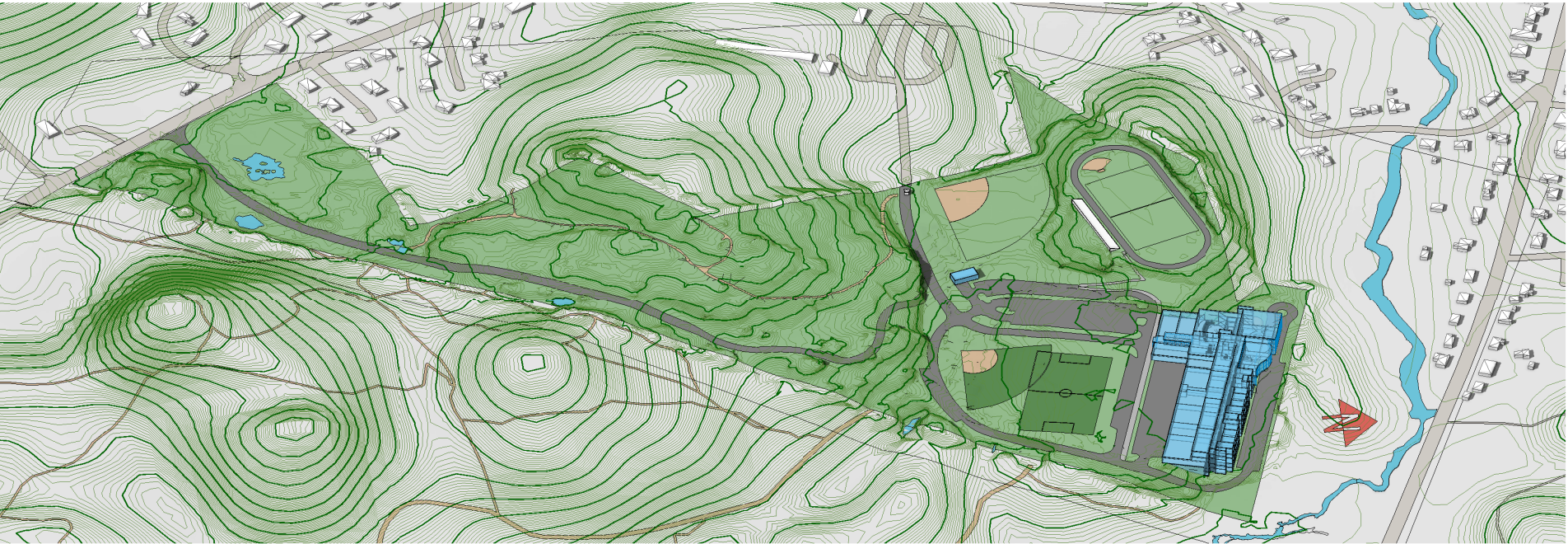

④ C.1 PROJECT COMPLETION, 2026



Option C.2 New Construction

Construction Phasing Diagrams



① C.2 SITE ENABLING PACKAGE; CONSTRUCTION OF ACCESS ROAD FROM FARM STREET BEGINS SUMMER 2022

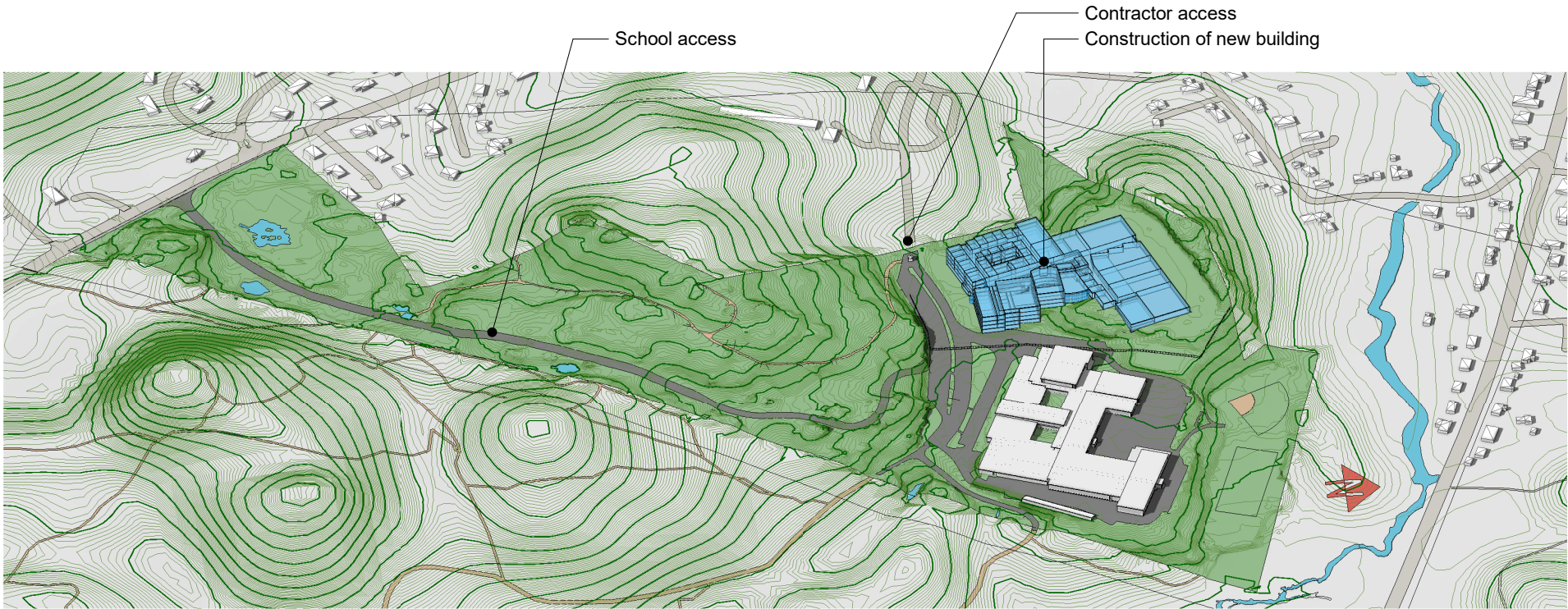

② C.2 CONSTRUCTION OF NEW SCHOOL BUILDING, BEGINS SUMMER 2023



Option C.2 New Construction

Construction Phasing Diagrams

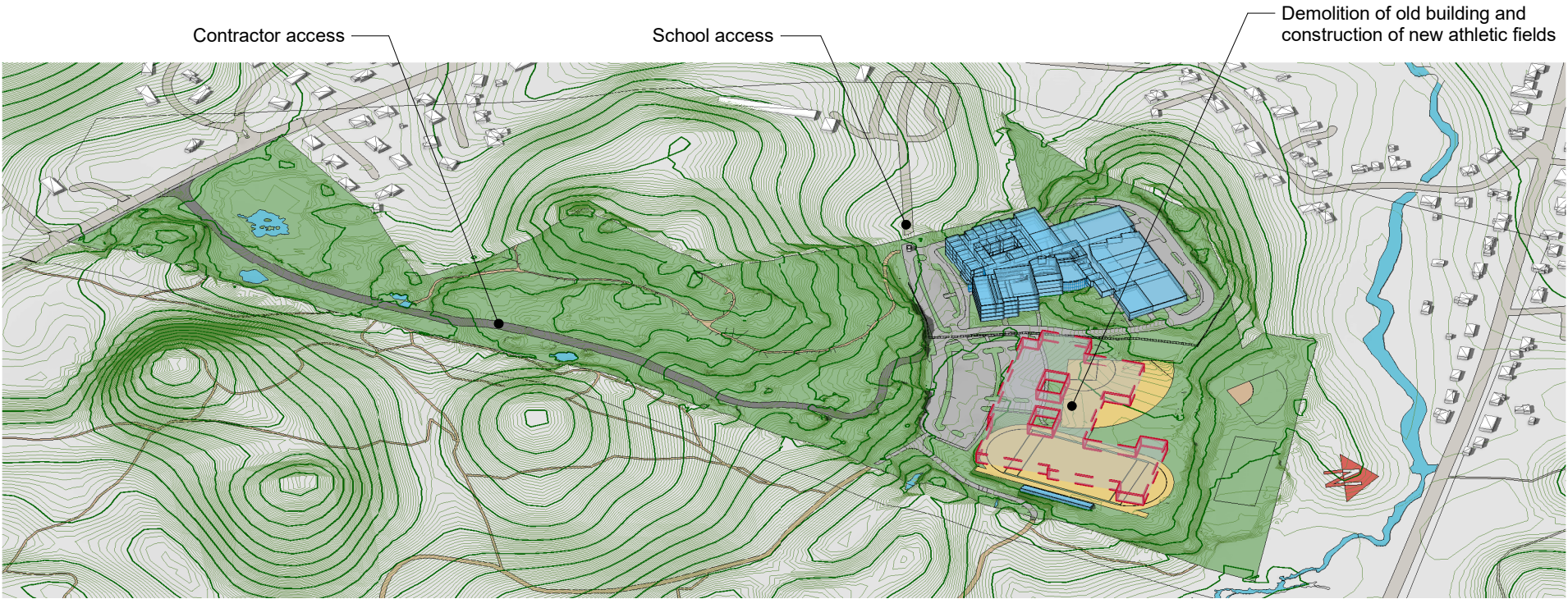

3 C.2 DEMOLITION OF EXISTING BUILDING AND CONSTRUCTION OF NEW ATHLETIC FIELDS

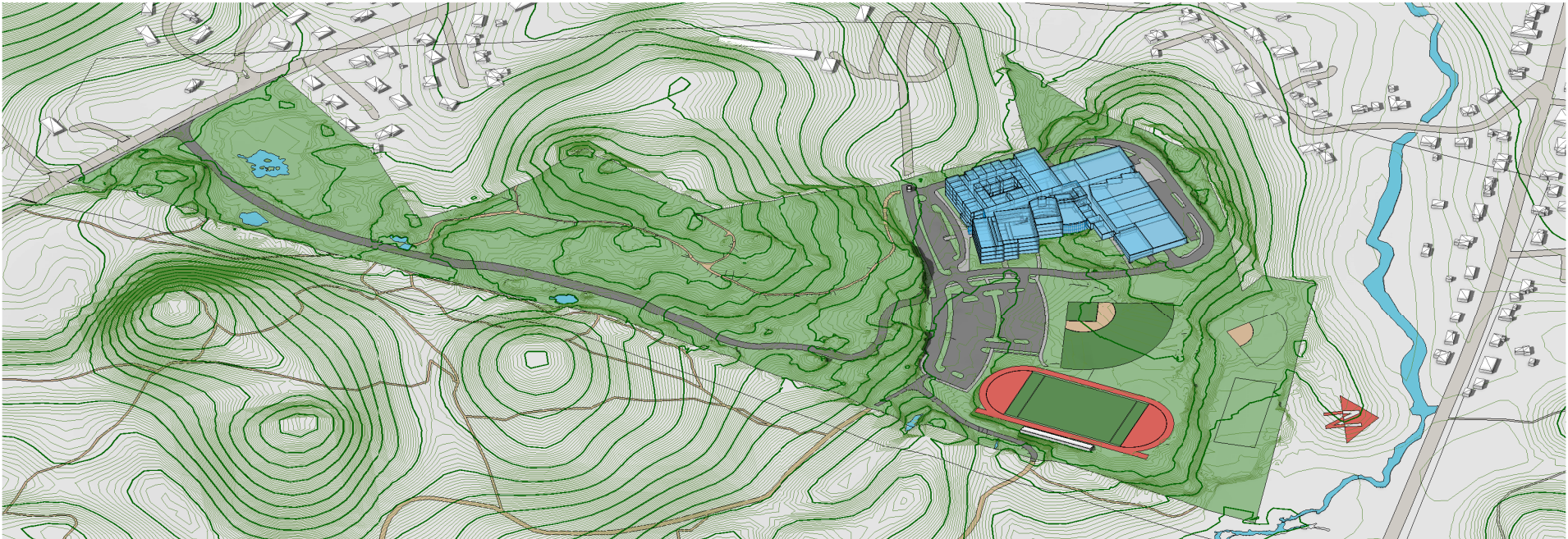

4 C.2 PROJECT COMPLETION, 2026



Option C.3 New Construction

Construction Phasing Diagrams

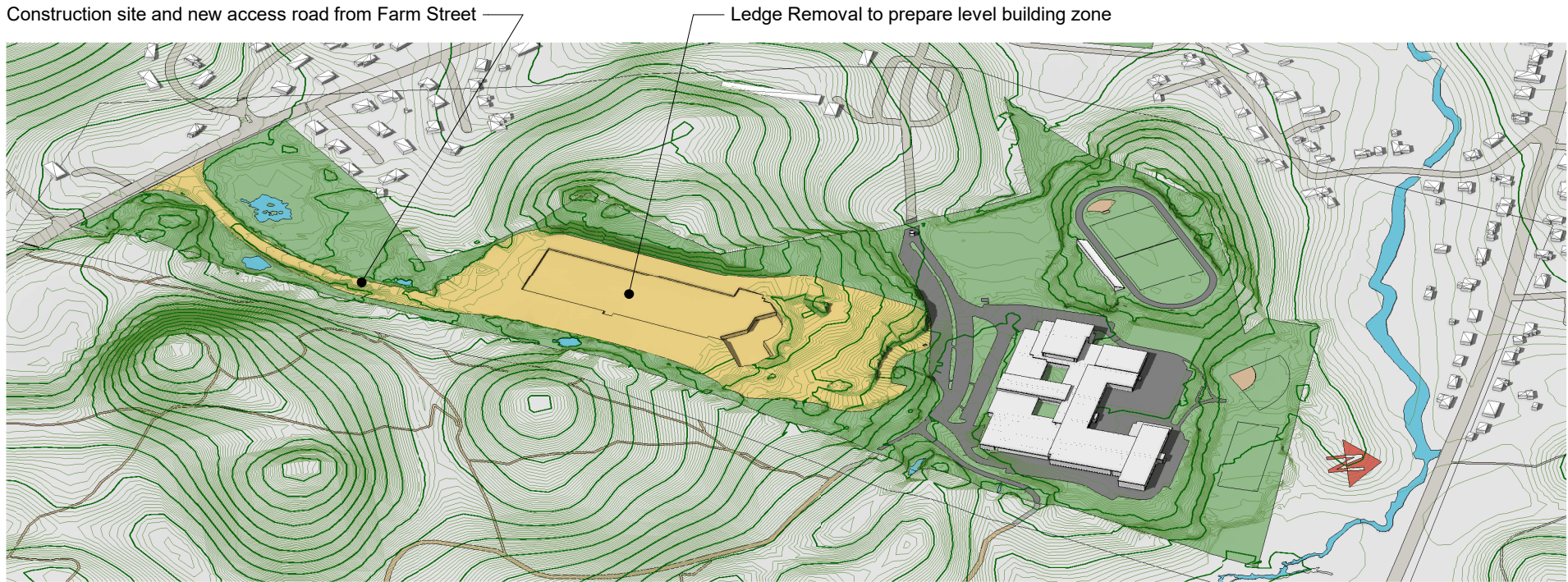

① C.3 SITE ENABLING PACKAGE; CONSTRUCTION OF ACCESS ROAD FROM FARM STREET BEGINS SUMMER 2022

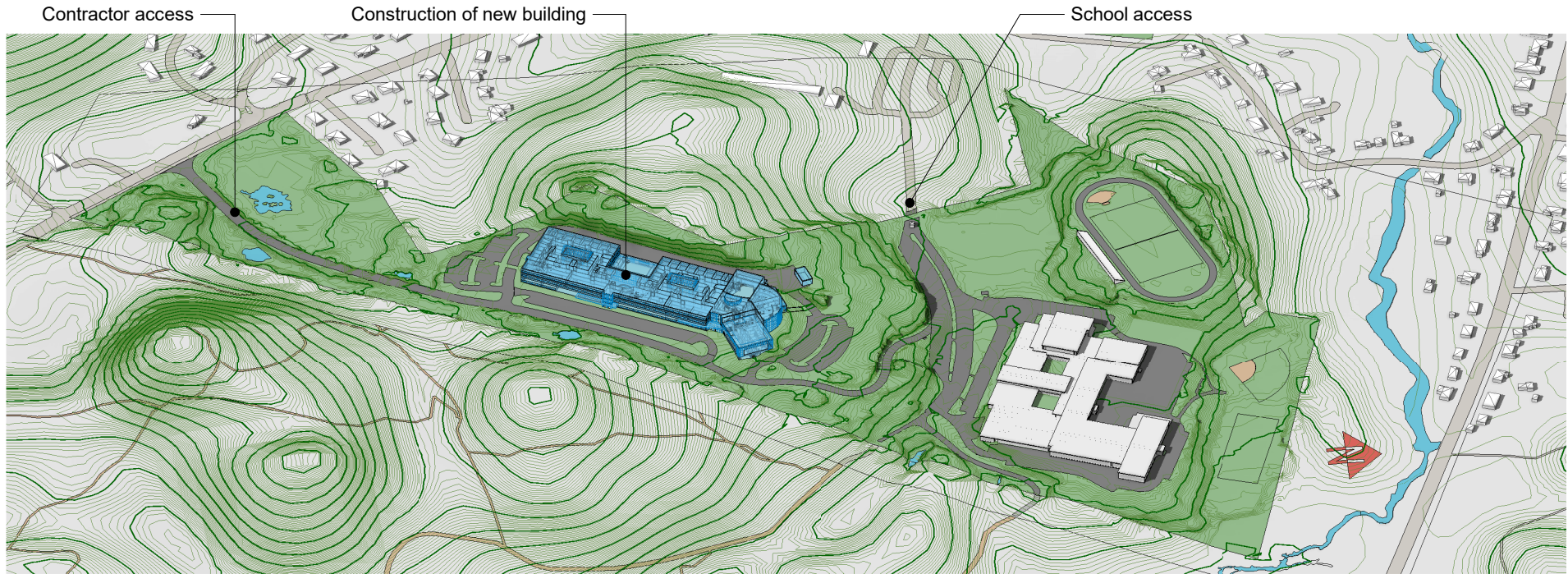

② C.3 CONSTRUCTION OF NEW SCHOOL BUILDING, BEGINS SUMMER 2023



Option C.3 New Construction

Construction Phasing Diagrams

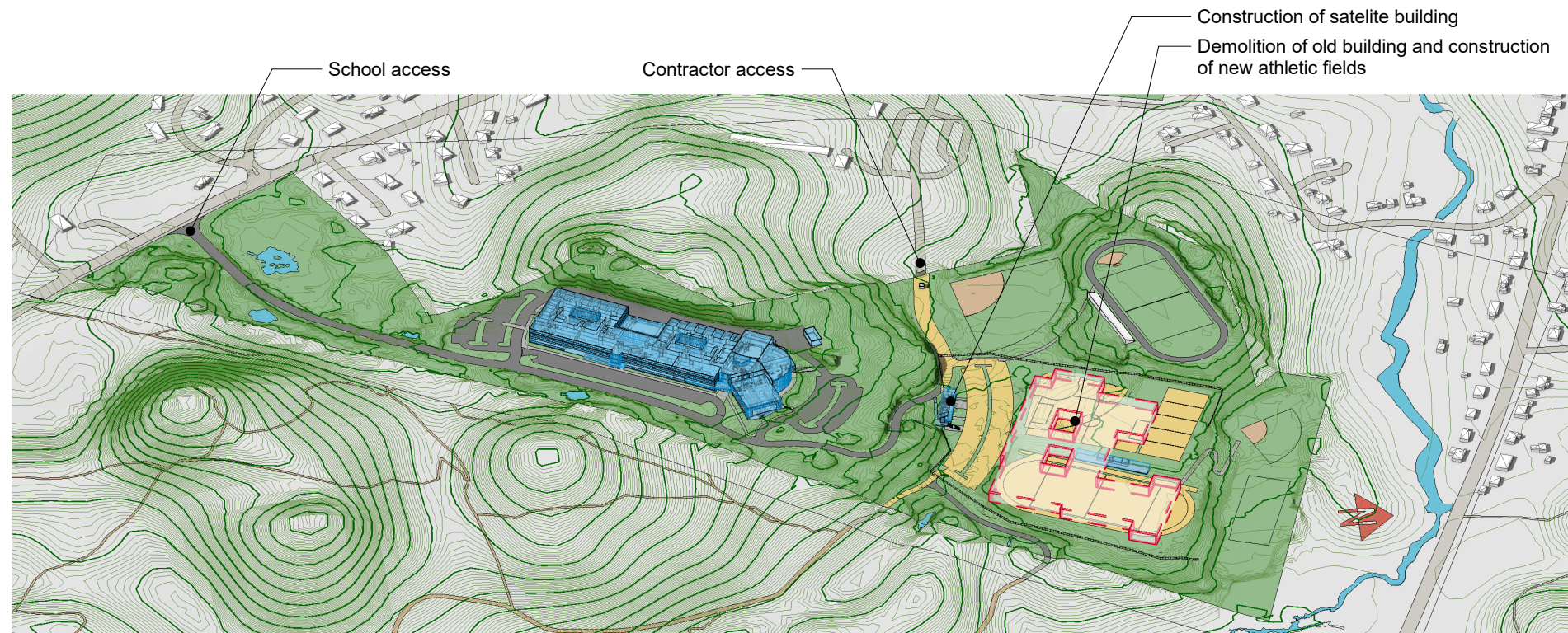

③ C.3 DEMOLITION OF EXISTING BUILDING AND CONSTRUCTION OF NEW ATHLETIC FIELDS



④ C.3 PROJECT COMPLETION, 2026