

SPACE SUMMARY

## DESE CHAPTER 74 MEETING SUMMARY

6C.3.2 – 07

## DESE CHAPTER 74 MEETING SUMMARY

## Meeting Dates

The project team met on two occasions with the Massachusetts Department of Elementary and Secondary Education (DESE) to discuss the Chapter 74 career/vocational technical education programs that are a part of the NE Metro Tech project.

We met on January 26<sup>th</sup>, 2023 with another meeting on February 13<sup>th</sup>, 2023 to continue discussions from the first meeting.

## In Attendance

DESE	Elizabeth Bennett & Lisa Sandler
MSBA	Allison Sullivan, Nina Pappacostas, Mary Pichetti & Lee Deveau
NE Metro Tech	Superintendent David DiBarri & Principal Carla Scuzzarella
PMA	Kevin Nigro, Joe DeSantis, Anthony LoPresti & Marco Zappala
DRA Architects	Vladimir Lyubetsky & Sarah Carda
Point Line Space	Aaron Constable & Pauravi Teabo

## Program Layout Changes Since DESE Meeting

Carpentry

Since our last meeting with DESE, design meetings have continued with the Carpentry department head. The layout of the shop floor has been revised to allow all the workbenches to be grouped together.

This revised layout improves the workflow from storage of materials, to cutting down materials, to refining materials and finally assembly at the worktables.

Attached is the revised equipment layout for Carpentry.

Cosmetology

Since our last meeting with DESE, design meetings have been held with the new Cosmetology department head. Layout of the shop has been revised to allow dual access the Facials and Dispensary rooms from either salon area.

Attached is the revised equipment layout for Cosmetology.

## DESE Review Comments

### Vocational Shop Signage

- Add an additional Fire Extinguisher Sign with a "Fire Blanket" added to the wording.

### Auto Collision Repair

- Equipment Item AC14, Vinyl Printer: Concern that printer needs to be ventilated. Point Line Space confirmed with the manufacturer and the Printer does not need to be ventilated.
- Discussion that career tech programs are moving towards tool chests and not tool cribs.
- Add an E-Stop in Related Classroom that deactivates any electrified equipment in this room.

### Automotive Technology

- Add a fire extinguisher with blanket in the Related Classroom and Small Engines Room.
- Add an E-Stop in Related Classroom that deactivates any electrified equipment in this room.
- Add an eye wash in the Small Engines Room.
- DESE commented that small engine work is not a large part of the framework. NE Metro responded that they are used to describe how a small combustion engine works and that there are many similarities to a vehicle's combustion engine. They use this space with Lower Classmen to provide a cursory understanding.

### Business Office Technology

- No comments.

### Carpentry

- Add an additional E-Stop on the shop floor near the CNC.

### Cosmetology

- No Comments

### Culinary Arts

- Add an E-Stop and Eyewash within the Theory Room.

### Dental Assisting

- At another school project, the doors at Intraoral and Pano rooms deactivate the power at the x-ray machines when opened.
- DESE questioned should there be E-Stops in each of the X-ray rooms. The Design Team stated that they typically do not add E-Stop in these spaces. DESE will review other projects and get back to the Design Team.

### Design and Visual Communications

- Add an additional E-Stop near the Hole Punch / Wire Stitcher.

### Drafting and Design

- Within the Maker Space add an E-Stop that deactivates any electrified equipment in this room.
- Existing 3-D Printers that are being relocated to the Maker Space do not require ventilation. DESE has asked the Design Team to look at current 3-D Printers on the market to confirm that the trend is not to ventilate these types of printers.

### Early Childhood Education

- DESE has asked the Design Team to confirm there are no protruding pipes on the Rooftop Playground.

#### Electrical Technology

- No comments.

#### Health Assisting

- No comments.

#### HVAC Technology

- No comments.

#### Metal Fabrications

- Add a fire blank to the fire extinguisher located near the corridor door.
- Add two additional fire extinguishers with blankets. One the right of the underclassmen welding booths and one to the right of the upperclassmen welding booths.

#### Plumbing & Pipefitting

- No comments.

#### Robotics & Automation

- Add a fire blanket to the fire extinguisher located in the Fabrication Lab.

#### Biotechnology

- Add eyewash in the Lab.

#### Marketing

- No comments.

#### Medical Assisting

- No comments.

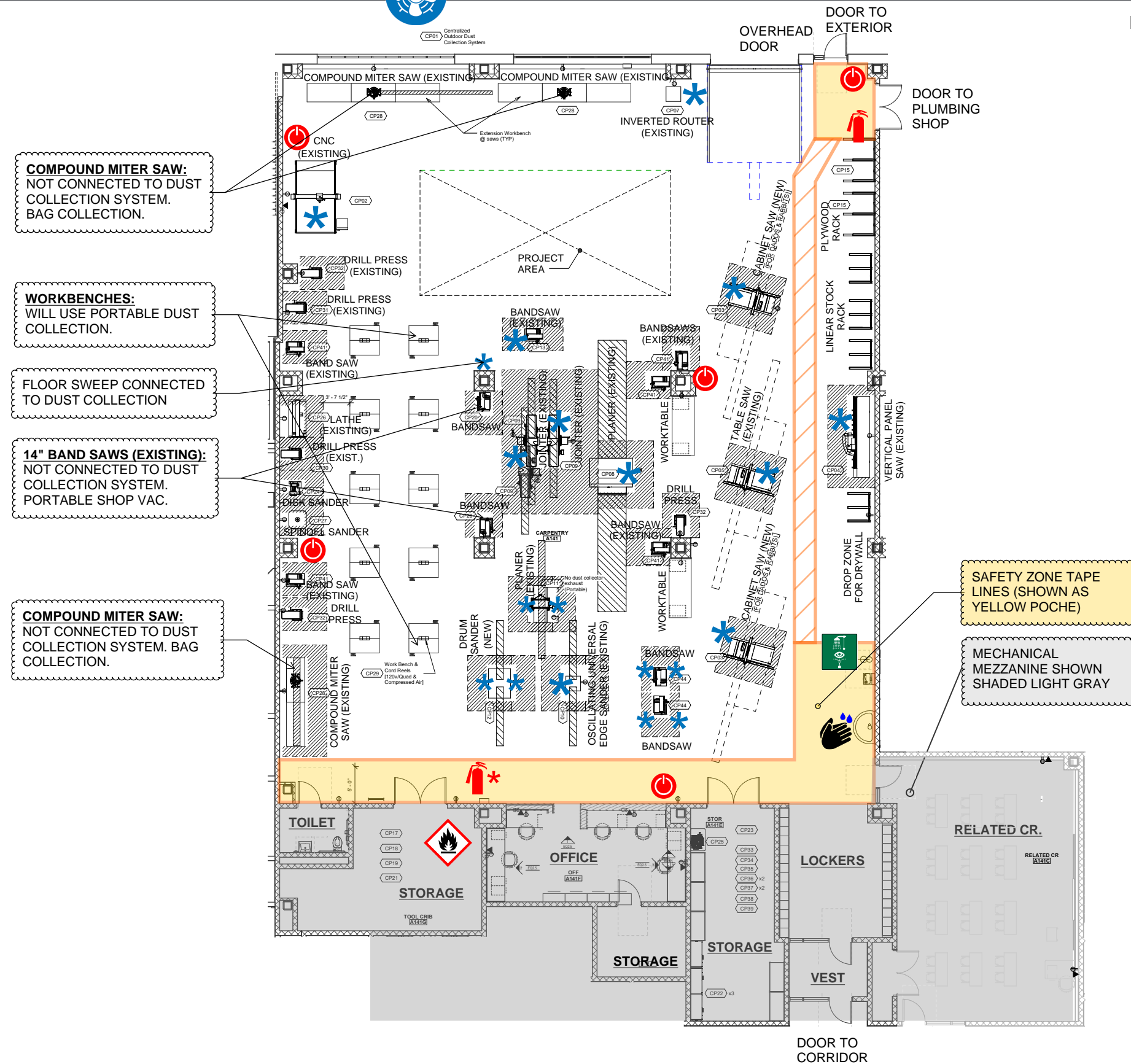

### Legend



Ventilation  
to Exterior  
Required



Emergency  
Power Off  
(EPO)



Emergency  
Shower/Eyewash  
Combination  
Unit



Emergency Eyewash



Fire Extinguisher

\*Includes Fire Blanket



Flammable  
Storage  
Cabinet



Goggle Cabinet



Hand  
Washing  
Station



Washer  
& Dryer



\*Equipment Connected to Dust Collector

 \*Includes Fire Blanket

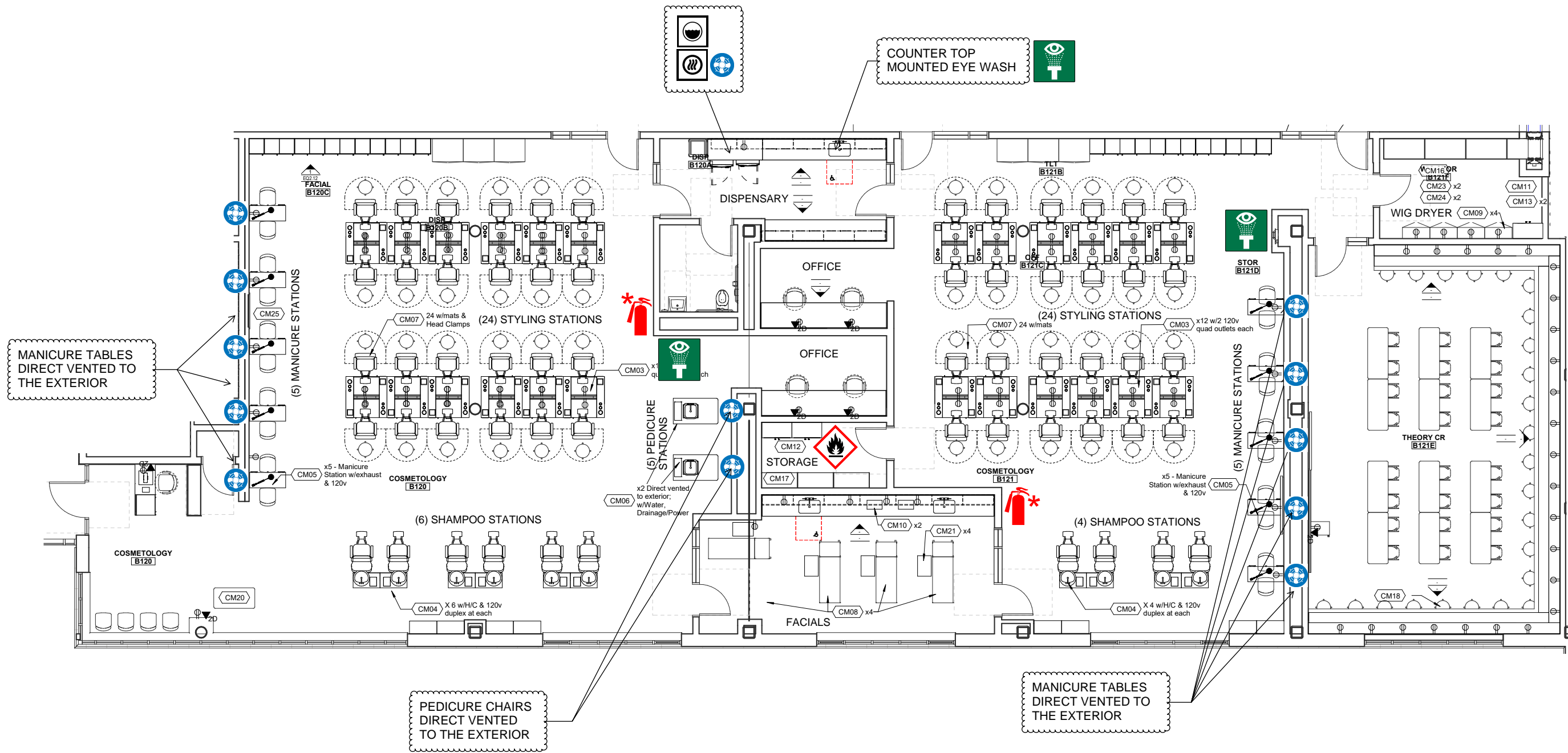

Legend



Ventilation to Exterior Required



Emergency Power Off (EPO)



Emergency Shower/Eyewash Combination Unit



Emergency Eyewash



Fire Extinguisher



Flammable Storage Cabinet



Goggle Cabinet



Hand Washing Station



Washer & Dryer



\*Equipment Vented to Exhaust Hood



\*Includes Fire Blanket